

- 1** Find a Podcatcher whose green light is constantly lit.
(If the yellow light is blinking you can still hand it out, but the last sync was more than 24 hours ago).

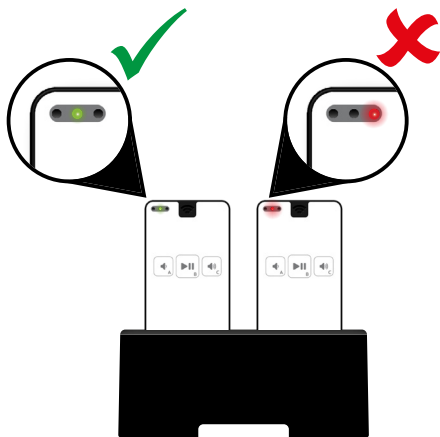

- 2** Take the Podcatcher out of the Dockingstation

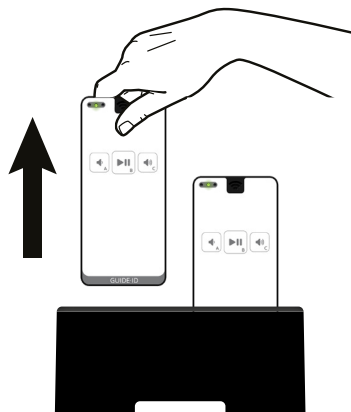

- 3** Aim at the start IDentifier of the desired tour / language.



- 4** The green light is on, the Podcatcher is ready for use.

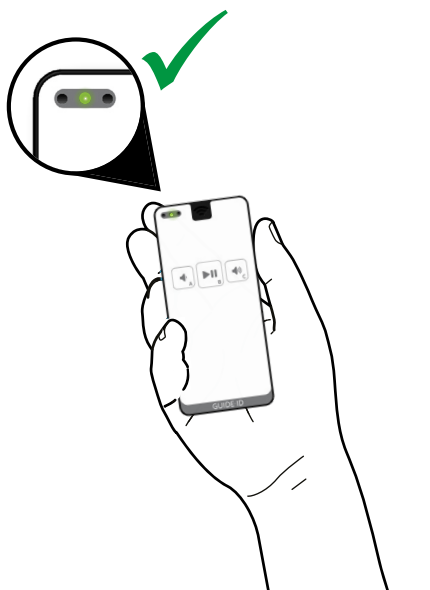

- 5** Hand the Podcatcher to the visitor.
If necessary, refer to the IDentifier instruction.

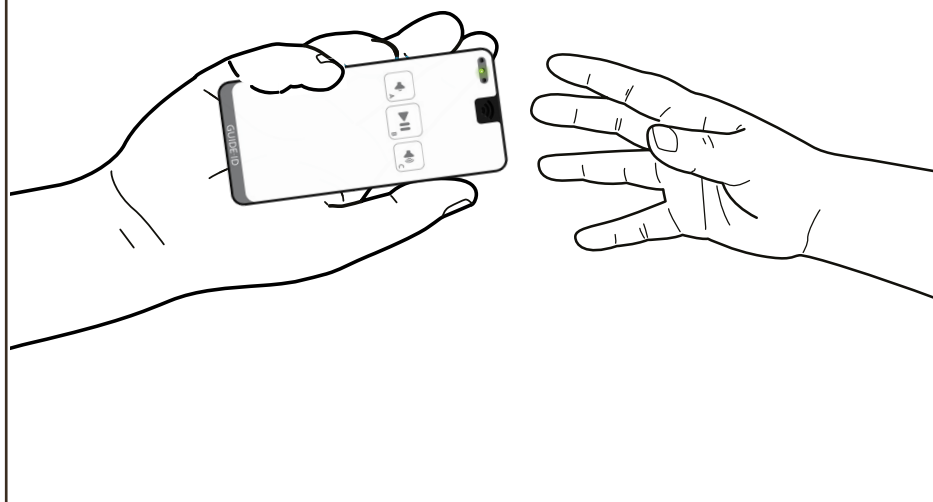

Intake on next page

1 The visitor hands over the Podcatcher



2 Ask if the visitor wants to do the survey on the Podcatcher. If you have one.



3 Visitor wants to do the survey.

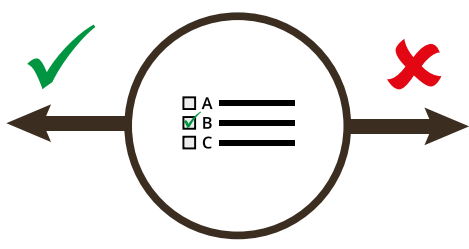

4 Visitor does not want to do the survey. (Or has already done that).

3^a Target the Survey IDentifier and let the visitor do the survey.

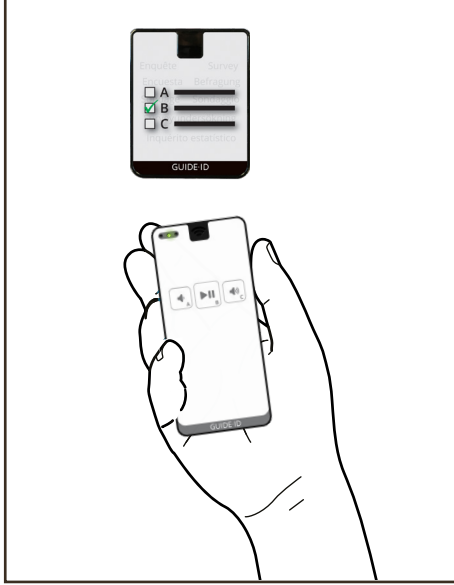

4^a Place the Podcatcher back into the Dockingstation

